

SETINA

LAW ENFORCEMENT VEHICLE EQUIPMENT

2926 Yelm Hwy SE - Olympia, WA 98501
(360) 491-6197 1-800-426-2627 Fax (360) 459-0729
Install Questions Contact us at: Install@setina.com

PB400 INSTALLATION INSTRUCTIONS

2016-2019 M/Y Interceptor Utility

- ✓ CAREFULLY READ INSTRUCTIONS BEFORE BEGINNING INSTALLATION.
- ✓ ALWAYS CHECK FOR FUEL LINES, BRAKE LINES, WIRING OR ANY OBSTRUCTIONS BEFORE DRILLING ANY HOLES!
- ✓ TO AVOID TAMPERING WITH FASTENERS ALWAYS PLACE WASHER AND NUTS AWAY FROM THE GUARDED AREA!!!

| BK0534ITU16 - Parts List | | | |
|--------------------------|-----|-------------|---|
| ITEM | QTY | PART NUMBER | DESCRIPTION |
| 1 | 2 | N/A | Rubber Pad |
| 2 | 1 | PB11043 | Backing Plate - Driver Sides |
| 3 | 1 | PB11044 | Backing Plate - Passenger Sides |
| 4 | 1 | PB11045 | Outer Lower Bracket - Driver Side |
| 5 | 1 | PB11046 | Outer Lower Bracket - Passenger Side |
| 6 | 1 | PB6561C | Outer Upper Bracket - Driver Side |
| 7 | 1 | PB6562C | Outer Upper Bracket - Passenger Side |
| 8 | 2 | PB9292B | Inner Lower Bracket - Both Side |
| 9 | 1 | PB9404 | Inner Clamp Bracket - Driver Side |
| 10 | 1 | PB9405 | Inner Clamp Bracket - Passenger Side |
| 11 | 1 | WB11284 | Push Bumper - Weldment (Shelf & Tube 33.25" Inside to Inside) |

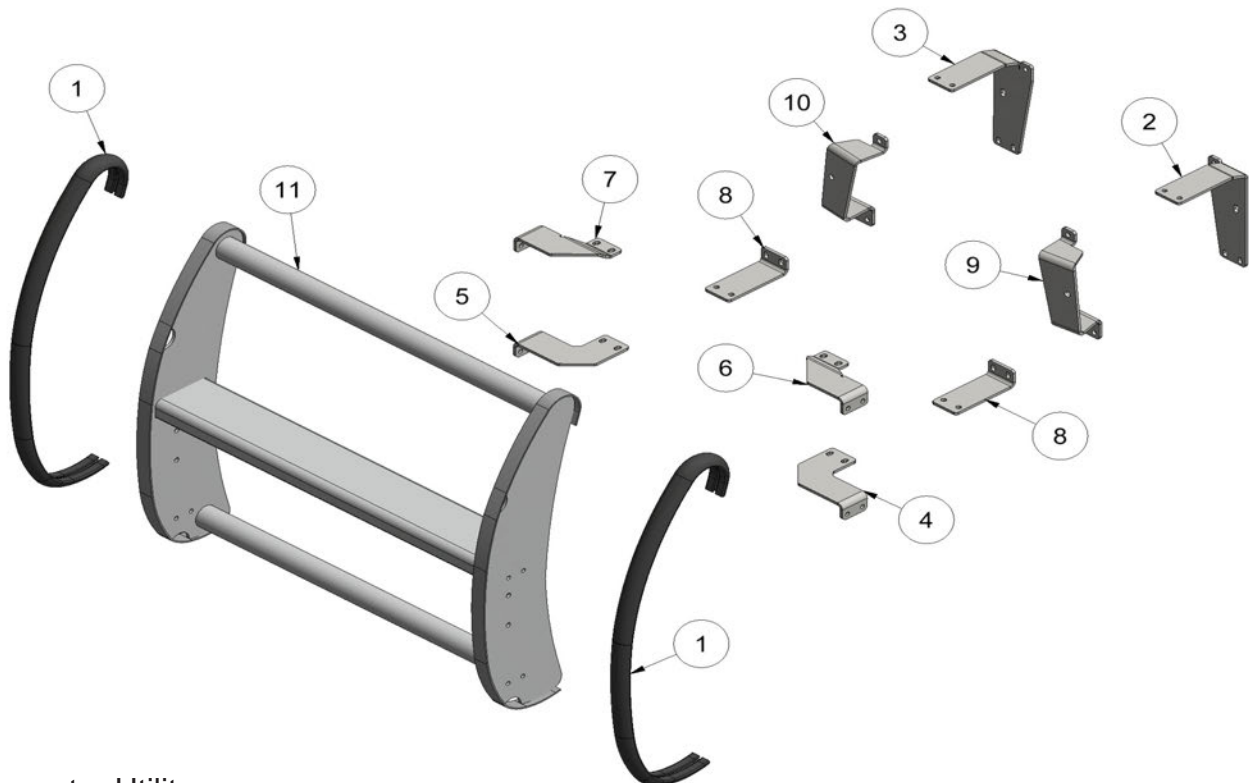

PB400 INSTALLATION INSTRUCTIONS

2016-2019 M/Y Interceptor Utility

Install Questions Contact us at: Install@setina.com

- ✓ CAREFULLY READ INSTRUCTIONS BEFORE BEGINNING INSTALLATION.
- ✓ ALWAYS CHECK FOR FUEL LINES, BRAKE LINES, WIRING OR ANY OBSTRUCTIONS BEFORE DRILLING ANY HOLES!
- ✓ TO AVOID TAMPERING WITH FASTENERS ALWAYS PLACE WASHER AND NUTS AWAY FROM THE GUARDED AREA!!!

| BB9368 - Bolt Bag Content | | | |
|---------------------------|----|---------------------------|-------------|
| ITEM | QT | DESCRIPTION | PART NUMBER |
| 1 | 2 | 3/8" x 1" HHCS Flanged | 37C100HFU8 |
| 2 | 2 | 3/8 x 3.50 Hex Head Bolt | 37C350HCS8 |
| 3 | 2 | 3/8 Flat Washer | 37NWUSY |
| 4 | 4 | 3/8" x 1.25" HHCS Flanged | 37C125HFU8 |
| 5 | 16 | 3/8" x 1" Torx Bolt | 37C100MTPY |
| 6 | 24 | 3/8" Wizlock | 37CNFU8 |

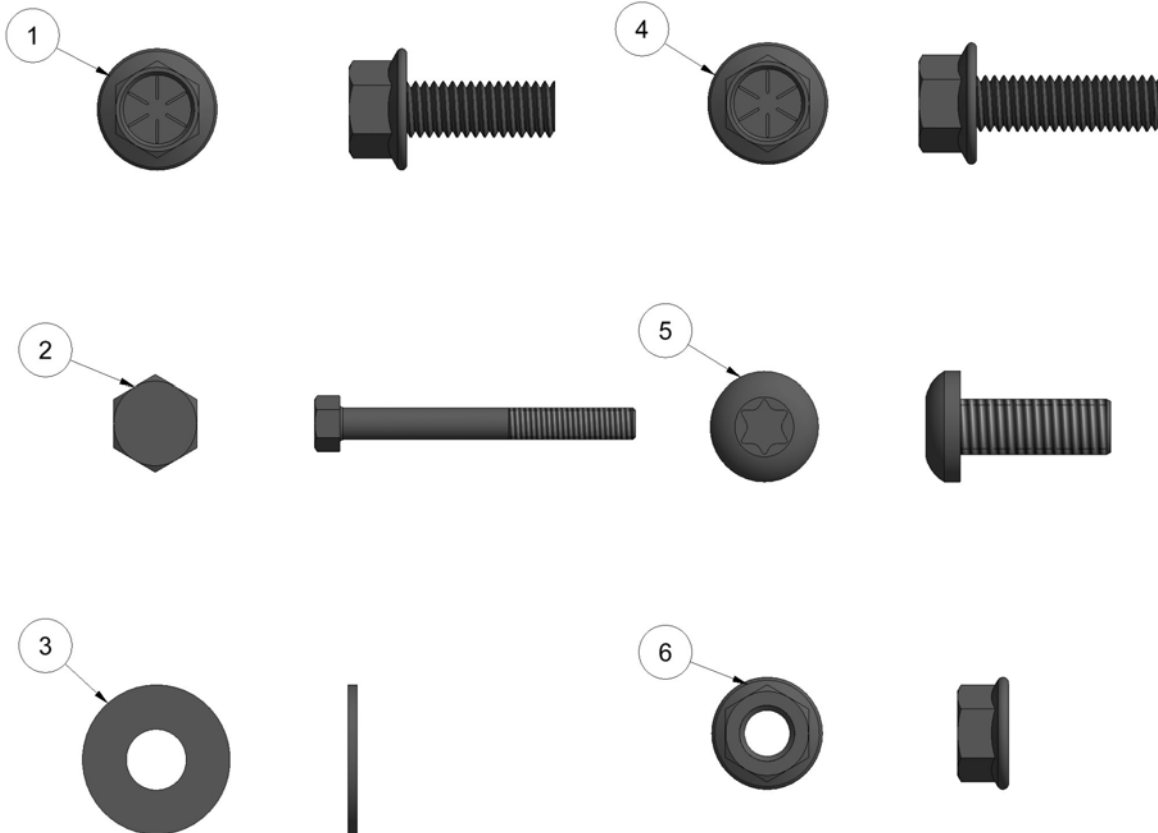

PB400 INSTALLATION INSTRUCTIONS

2016-2019 M/Y Interceptor Utility

Install Questions Contact us at: Install@setina.com

- ✓ CAREFULLY READ INSTRUCTIONS BEFORE BEGINNING INSTALLATION.
- ✓ ALWAYS CHECK FOR FUEL LINES, BRAKE LINES, WIRING OR ANY OBSTRUCTIONS BEFORE DRILLING ANY HOLES!
- ✓ TO AVOID TAMPERING WITH FASTENERS ALWAYS PLACE WASHER AND NUTS AWAY FROM THE GUARDED AREA!!!

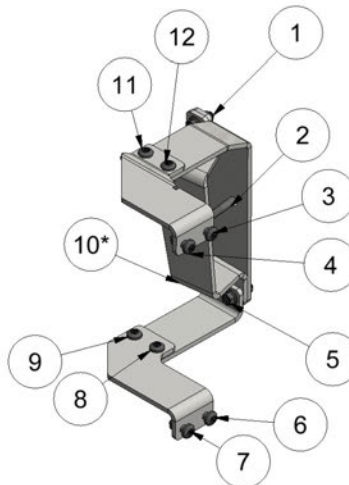
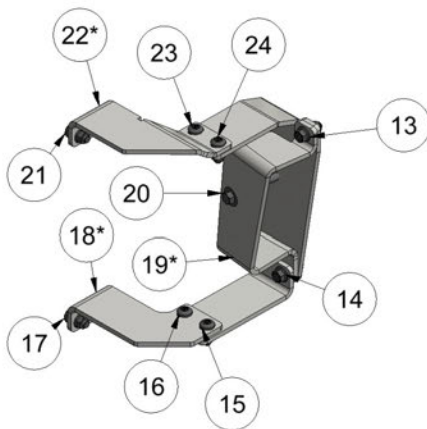
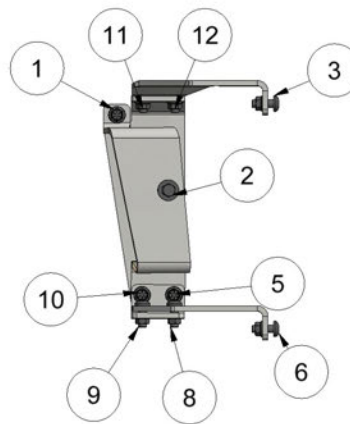
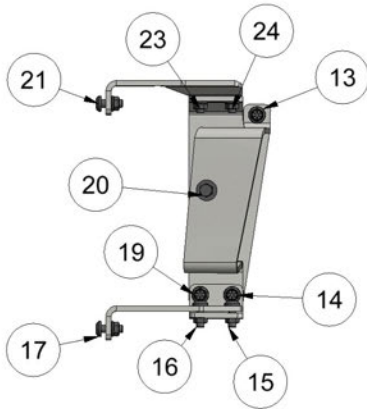

| BOLT CHART | |
|------------|-----------------|
| ITEM | TORQUE (ft-lbs) |
| 1 | 33 |
| 2 | 33 |
| 3 | 33 |
| 4 | 33 |
| 5 | 33 |
| 6 | 33 |
| 7 | 33 |
| 8 | 33 |
| 9 | 33 |
| 10 | 33 |
| 11 | 33 |
| 12 | 33 |
| 13 | 33 |
| 14 | 33 |
| 15 | 33 |
| 16 | 33 |
| 17 | 33 |
| 18* | 33 |
| 19 | 33 |
| 20 | 33 |
| 21 | 33 |
| 22* | 33 |
| 23 | 33 |
| 24 | 33 |



Setina Mfg. Co., Inc.

PH. (360) 491-6197 or 1-800-426-2627 FX. (360) 459-0729

2011 - Interceptor_Explorer_ECO - PB400 Push Bumper - Torque Specs

| SIZE | DRAWN BY | CHECKED BY | PART # | REV |
|------|-------------|------------|-------------|------|
| A | ino | | BK0534ITU12 | |
| | DESIGNED BY | | | |
| | Adam S. | | | |
| | DATE | | SHEET 1 | OF 1 |
| | 4/29/2015 | | | |

***NOT VISIBLE IN DRAWING**

2016 Interceptor Utility

©2015 Setina Mfg. Co. Inc. REV 12/30/16

PB400 INSTALLATION INSTRUCTIONS

2016-2019 M/Y Interceptor Utility

Install Questions Contact us at: Install@setina.com

- ✓ CAREFULLY READ INSTRUCTIONS BEFORE BEGINNING INSTALLATION.
- ✓ ALWAYS CHECK FOR FUEL LINES, BRAKE LINES, WIRING OR ANY OBSTRUCTIONS BEFORE DRILLING ANY HOLES!
- ✓ TO AVOID TAMPERING WITH FASTENERS ALWAYS PLACE WASHER AND NUTS AWAY FROM THE GUARDED AREA!!!

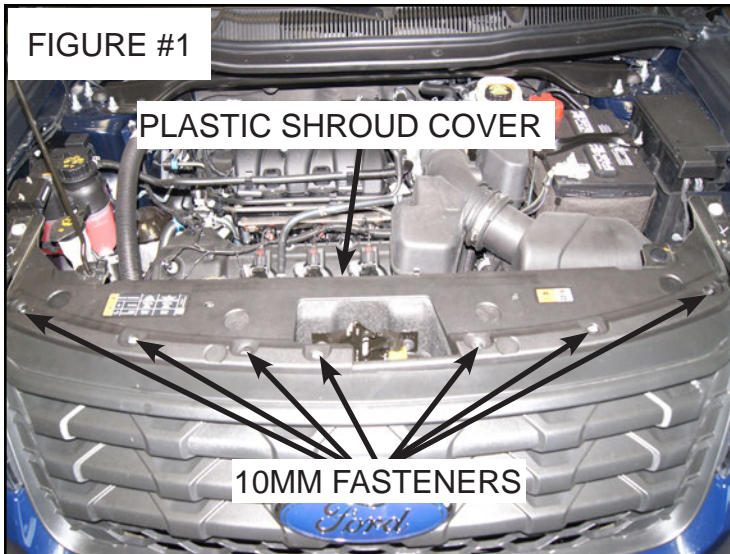

(Setina push bumper is not compatible with vehicles equipped with the (Y66) Adaptive cruise control or front park assist.)

STEP #1: Open the hood of the vehicle and remove the 10mm fasteners securing the plastic shroud cover the fascia. See Figure #1.

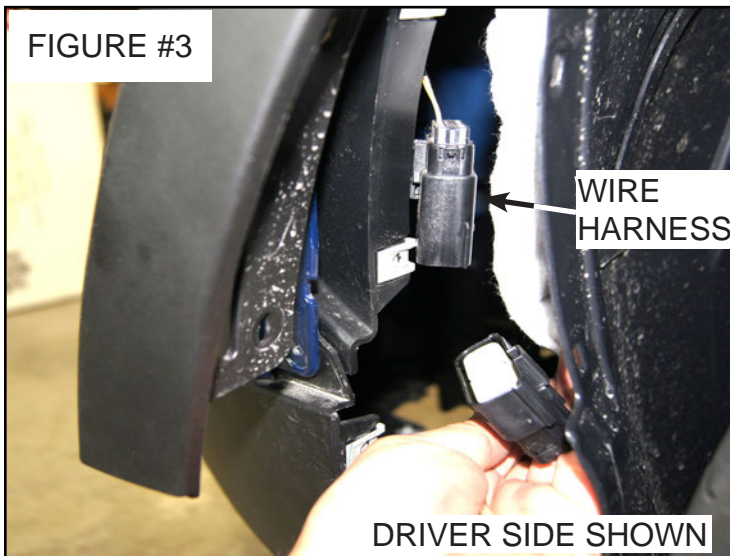

STEP #3: Locate and unplug the wire harness within the driver side wheel well. See Figure #3.

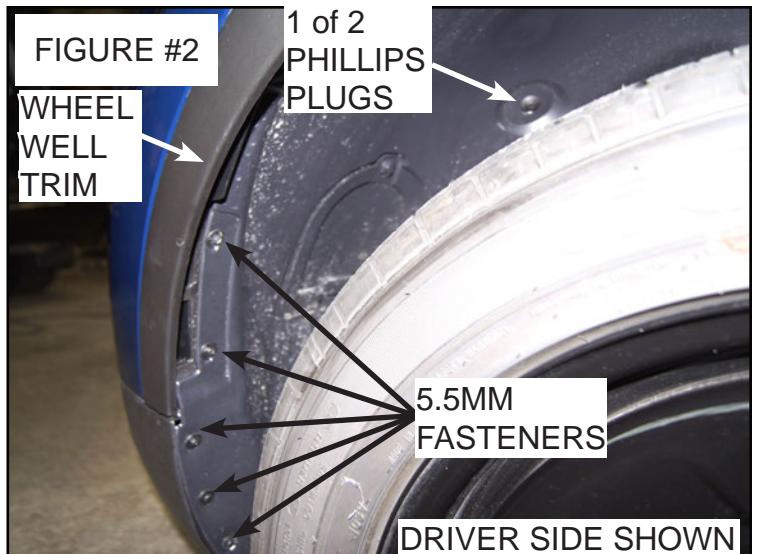

STEP #2: Move to the wheel wells and remove the 5.5mm fasteners securing the wheel well trim and cover to the vehicle. See Figure #2. (Remove the (2) Phillips plastic plugs to allow the well cover to flex.) Repeat for passenger side.

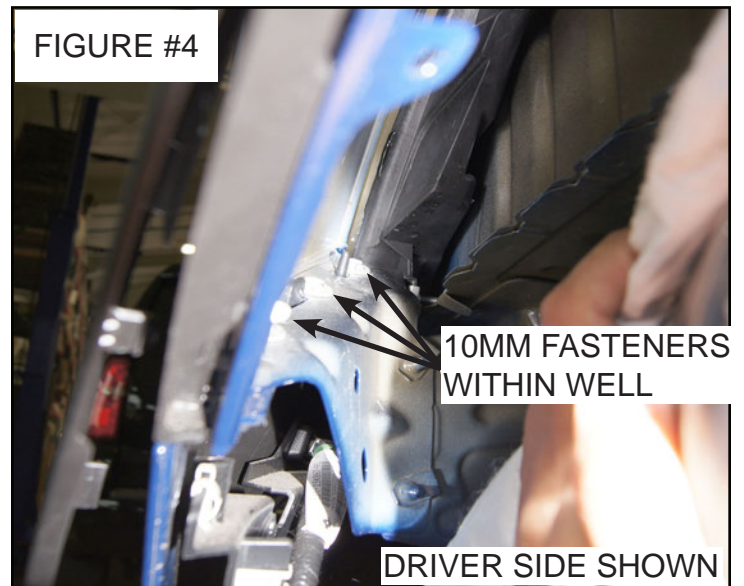

STEP #4: Pull the wheel well cover back. Locate and remove the (3) 10mm fasteners securing the fascia to the fender. See Figure #4. Repeat for passenger side.

PB400 INSTALLATION INSTRUCTIONS

2016-2019 M/Y Interceptor Utility

Install Questions Contact us at: Install@setina.com

- ✓ CAREFULLY READ INSTRUCTIONS BEFORE BEGINNING INSTALLATION.
- ✓ ALWAYS CHECK FOR FUEL LINES, BRAKE LINES, WIRING OR ANY OBSTRUCTIONS BEFORE DRILLING ANY HOLES!
- ✓ TO AVOID TAMPERING WITH FASTENERS ALWAYS PLACE WASHER AND NUTS AWAY FROM THE GUARDED AREA!!!

FIGURE #5

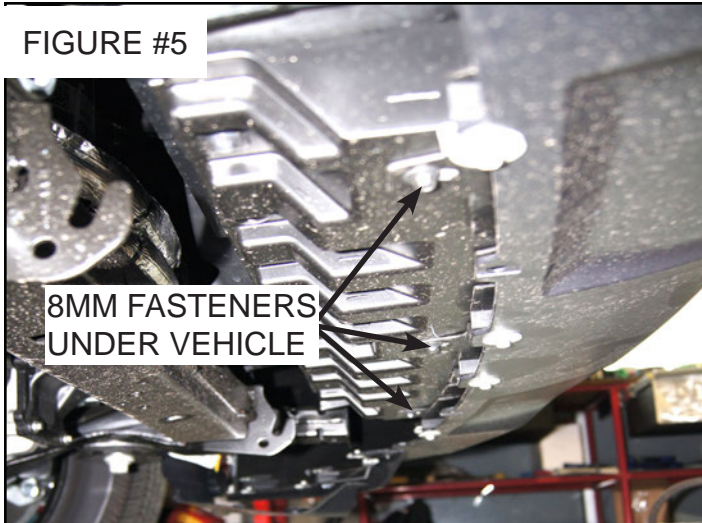

STEP #5: Move to the under carriage of the vehicle. Remove the plastic skid plate. Locate and remove the (3) 8mm fasteners shown in figure #5. Pull firmly on the outer edge of the fascia and remove from the vehicle.

FIGURE #6

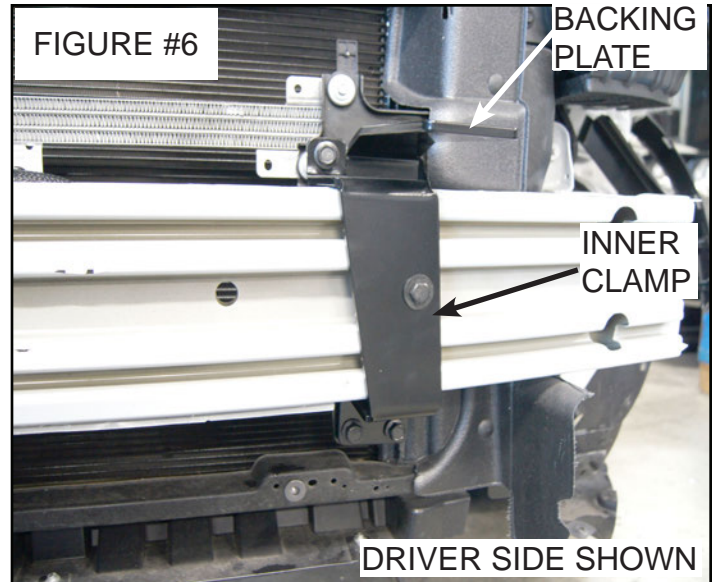

STEP #6: Secure the backing plate and inner clamp bracket loosely with the provided 3/8" x 3.5" bolts, 3/8" flat washer and 3/8" wizlocks. Secure the upper mounting point loosely using the provided 3/8" x 1" Flanged bolt and 3/8" wizlock. See Figure #6. Repeat for the passenger side.

FIGURE #7

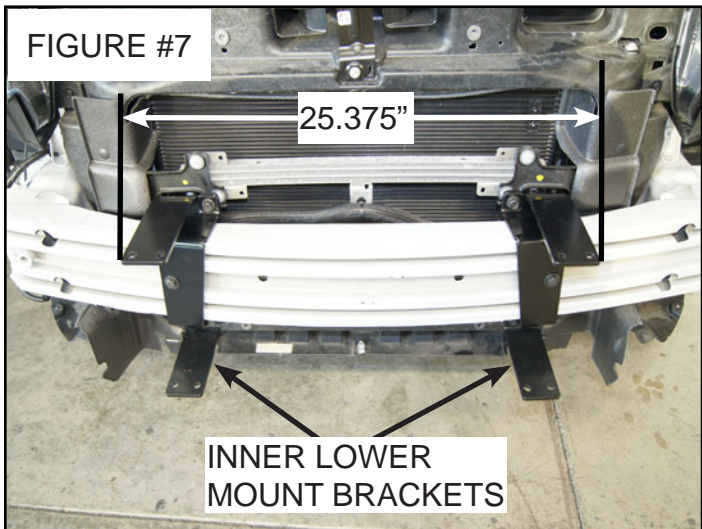

STEP #7: Secure the inner lower mounting bracket loosely to the inner clamp and backing plate with the 3/8" x 1.25" Flanged bolt and 3/8" wizlock. Level the brackets and tighten the fasteners. (Brackets should measure 25.375" outside to outside.) See Figure #7. **(If installing PB5 or Headlight guards install inner bracket at this time.)**

FIGURE #8

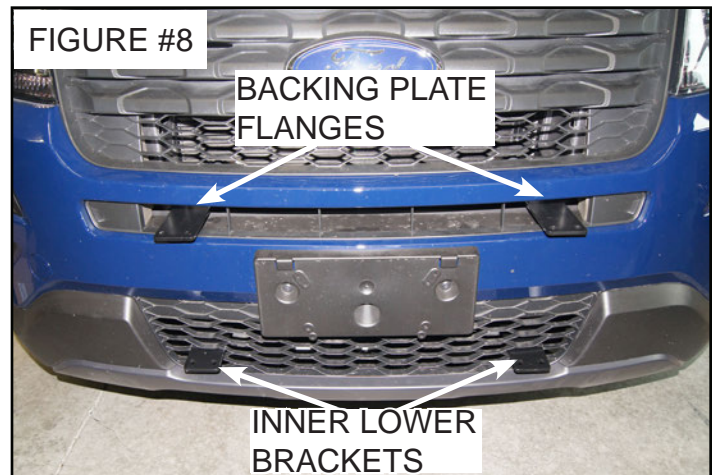

STEP #8: Return the fascia to the vehicle. The backing plate flange will protrude through the large upper openings. The lower inner mounting brackets will protrude through the 2nd full honeycomb up and in from the outer edge. See Figure #8.

PB400 INSTALLATION INSTRUCTIONS

2016-2019 M/Y Interceptor Utility

Install Questions Contact us at: Install@setina.com

- ✓ CAREFULLY READ INSTRUCTIONS BEFORE BEGINNING INSTALLATION.
- ✓ ALWAYS CHECK FOR FUEL LINES, BRAKE LINES, WIRING OR ANY OBSTRUCTIONS BEFORE DRILLING ANY HOLES!
- ✓ TO AVOID TAMPERING WITH FASTENERS ALWAYS PLACE WASHER AND NUTS AWAY FROM THE GUARDED AREA!!!

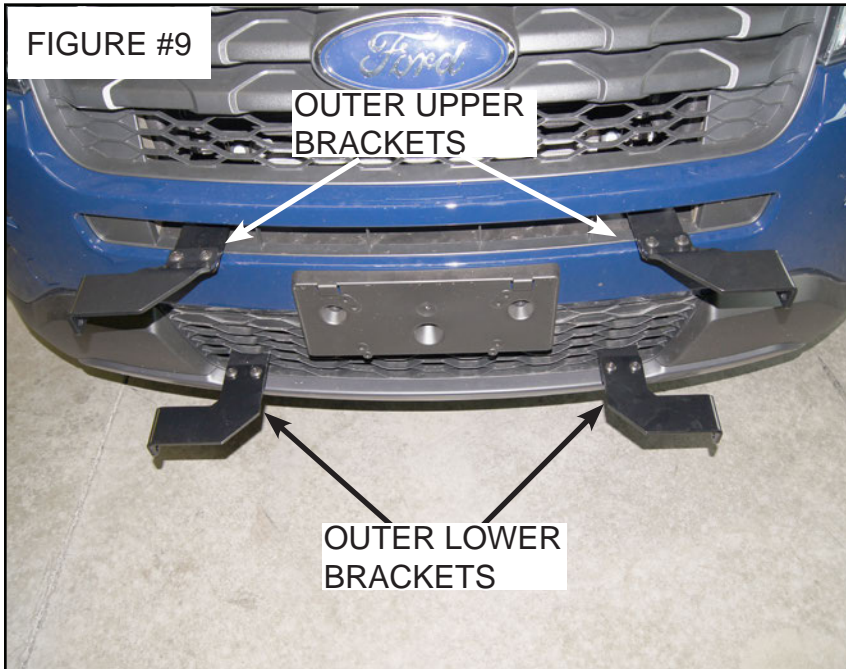

STEP #9: Reconnect the wire harness on the driver side. Fully secure fascia to vehicle. Loosely attach the outer mounting brackets with the provided 3/8" x 1" TORX bolt and 3/8" wizlock. See Figure #9.

STEP #11: Lift the push bumper weldment up to the mounting brackets and secure using the 3/8" x 1" Torx bolts and 3/8" wizlock. Level push bumper and tighten all fasteners to complete the install.

